

MUREXIN

Everything sealed - guaranteed!

Standards | System components | Products

Tiling System



It lasts.

SEALING

in the private and public areas.

The products are classified in accordance with EN 14891, ÖNORM B 2207 ÖNORM B 3407 or the ZDB technical data sheet.



Revised standards with adaptations to current requirements

A new revised version of ÖNORM B 3407, published in 2015, has been available since 2019.

The most notable differences between the old and new editions are the changed definition of large formats, the narrowing of the covering and covering expansion joints, and the new formatting of the table of moisture load classes, including the omission of

the presentation of structural sealing. The latter are now described exclusively in the building sealing standards ÖNORM B 3691 and 3692.

You can find suitable seals according to the new ÖNORM B 3407 in the following table:

Moisture load						Liquid Film 1 KS	Professional Sealing Film Rapid Maximo PSM 1K	Grey Sealing Adhesive Mortar DKM 95	Liquid Film 2 KS	Special Seal X-Bond MS-A99	Universal Seal PU 500	Sealing and Decoupling Membrane AE 100
Load class	Examples of application areas	Laying surface for the covering	Gradient	Drainage	Compound seal							
W1 very low Water load Areas with infrequent, short-term effect from mopping water	Living area: Living rooms, corridor area, WCs, offices, etc.	Sensitive to moisture ^c and not sensitive to moisture ^d	No gradients required at floor covering level	No drains required	None Special measures required	✓	✓	✓	✓	✓	✓	
W2 low water load Areas with infrequent, short-term effect from mopped and sprayed water	Operational area: WC facilities; living area: kitchens or rooms with similar use					✓	✓	✓	✓	✓	✓	
W3 moderate water load Areas with frequent short-term effect from mopped and sprayed water	Bathrooms, with shower trays installed higher than 2 cm above the floor ^b or bathtub, floor surfaces in WC facilities without floor drain; vestibules in public areas with moisture-sensitive substrates					✓	✓	✓	✓	✓	✓	
W4 high water load Areas with frequent, long-term effects from mopping, spray and process water	Wall ^a - and floor areas with drainage: e.g. WC facilities, bathroom, showers with in-built parts at the same level ^b , laundry rooms	Not sensitive to moisture ^d	gradient required at floor level	wall or floor drain required at floor level	Compound seal for tiles/ceramic coverings in accordance with 6.4 ÖNORM B 3407	✓	✓	✓	✓	✓	✓	
W5 very high water load Areas with permanent effects from mopping water, spray and process water and/or increased chemical effect	Swimming pool surrounds, shower facilities, operational industrial production sites such as laboratories, food processing plants, canteens					x	✓	✓	✓	✓	✓	
W6 outdoors Outdoor areas	Balconies, terraces, loggias, stairways, open pergolas					x	✓	✓	✓	✓	✓	
a	Affects floor-level drains in wall surfaces; Closed drains, such as washing machine and sink drains, are not affected	✓ suitable										
b	All shower trays that are offset up to 2 cm higher or lower than the adjacent floor covering are considered to be level	x not suitable										
c	Moisture-sensitive substrates, e.g. calcium sulphate screeds, wood-based materials, gypsum materials. Gypsum plasters may only be used in shower areas of moisture class W3 if they are expressly approved by the manufacturer for this area of application	Necessary structural sealing depending on the moisture load and the substrates are contained in ÖNORM B 3692:2014, Table 8.										
d	Largely moisture-insensitive substrates, e.g. concrete, cement-based plasters and cement-bound, mineral building boards											

Everything sealed - guaranteed!

Murexin sealing products

High demands are placed on the seals, particularly in areas that are subject to increased moisture. In order to meet these, the Europe-wide applicable standard EN 14891 should be observed.



EN 14891

This standard is recognised throughout Europe and applies to all liquid processed waterproof products which consist of layers based on polymer-modified cement-mortar, dispersion and reaction resins and which are used under ceramic tiles and slabs for walls and floors in indoor and outdoor areas as well as in swimming pools.

The fundamental characteristics include checking the tensile strength values within the system (i.e. concrete substrate – primer – seal – tile adhesive – tile) for dry, water, heat, freeze/thaw as well as lime water storage. In addition, checking the water-impermeability with a much higher pressure than before is also on the program.

Even the crack bridging is checked with a completely new method. You may also check the seal for resistance to chlorinated water (P) as well as to the crack bridging at low temperatures (O1 down to -5 °C, O2 down to -20 °C).

The criteria for water-impermeable products can be separated into three classes depending on the chemical base and are identified by the letter labels:

- CM** Liquid water-impermeable products based on cement mortar
- DM** Liquid water-impermeable products based on dispersions
- RM** Liquid water-impermeable products based on reaction resins

You can have different classes for each of these types with regard to the additional properties:

- O1** Capable of crack bridging at low temperatures down to -5 °C
- O2** Capable of crack bridging at low temperatures down to -20 °C
- P** Adherent after exposure to chlorinated water (e.g. swimming pools)

Murexin system components for wet rooms

SYSTEM STRUCTURE PIPE CONNECTION / WALL

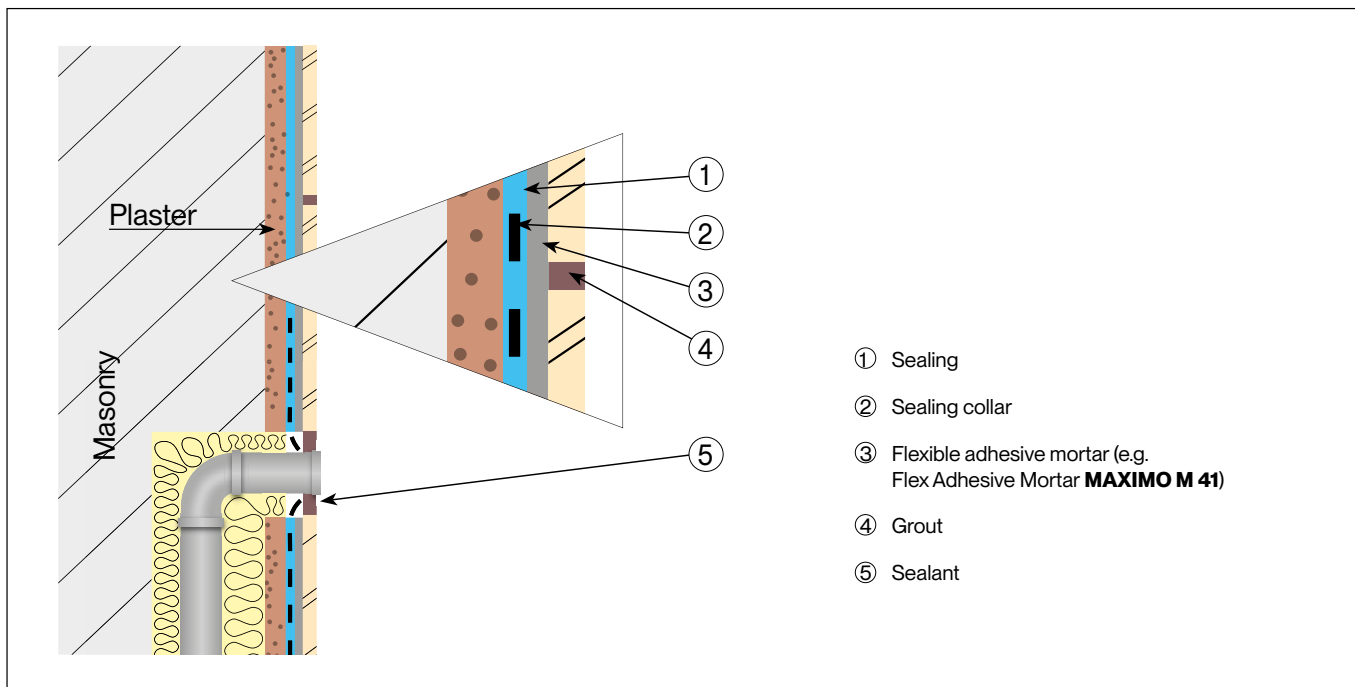

SYSTEM STRUCTURE FLOOR / WALL CONNECTION

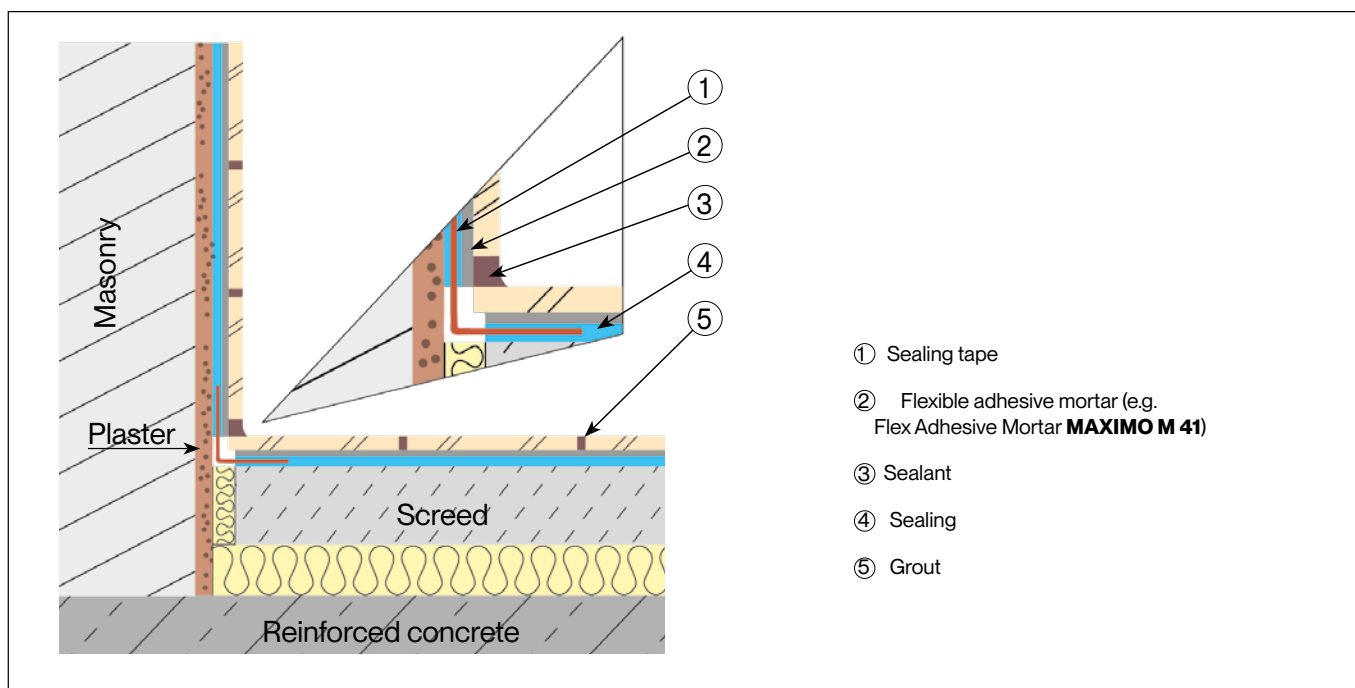

The products



Liquid Film **1KS**

Quick drying, solvent-free, water-impermeable, single-component, permanently elastic, seamless and jointless compound seal. Indoor use only for jointless sealing of wall and floor surfaces in wet areas to protect against pressureless draining water directly below the ceramic covering. According to EN 14891, ÖNORM B 3407 W1-W4 and according to DIN 18534 for water impact class W0-I, W1-I, W2-I (wall) as well as according to the test principles for the issue of a general building inspection test certificate.

Consumption: approx. 1.5 kg/m² per mm layer thickness (approx. 0.8 kg/m² per 0.5 mm layer thickness)



Liquid Film **2KS**

Quick hardening, seam and jointless, two-component, low temperature elastic compound seal. Indoors and outdoors for jointless sealing of wall and floors areas under the ceramic covering in showers, bathrooms, on terraces and balconies. According to EN 14891, ÖNORM B 3407 W1-W6, according to DIN 18534 for water impact class W0-I to W3-I (for W3-I without additional chemical load), according to DIN 18531-5 (balconies, loggias, etc.) and DIN 18535 (swimming pools and containers), as well as according to the test principles for the issue of a general building inspection test certificate.

Consumption: approx. 1.5 kg/m² per mm layer thickness (approx. 3 kg/m² per 2 mm layer thickness)



Professional Sealing Film Rapid **MAXIMO PSM 1K**

Quick hardening, highly efficient, hydraulically setting, solvent-free, water-impermeable, but still water vapour permeable, flexible single-component sealing slurry for the creation of seamless and jointless compound seals for the wall and floor area of indoor and outdoor areas, for jointless sealing of wall and floor area directly under the ceramic covering. For application on balconies, terraces and swimming pools (down to 4 m) as well as underfloor heating systems. Tiling is possible after three hours. According to EN 14891, ÖNORM B 3407 W1-W6, according to DIN 18534 for water impact class W0-I to W3-I (for W3-I without additional chemical load), according to DIN 18531-5 (balconies, loggias, etc.) and DIN 18535 (swimming pools and containers), as well as according to the test principles for the issue of a general building inspection test certificate.

Consumption: approx. 1.15 kg/m² per mm layer thickness (approx. 2.3 kg/m² per 2 mm layer thickness)



Sealing Adhesive Mortar Grey **DKM 95**

New type of hydraulically setting, water impermeable but still vapour-permeable, cementitious, flexible, single-component sealing AND adhesive mortar. Indoors and outdoors for creating seamless and jointless seals in wall and floor areas directly under ceramic tiles and boards (according to EN 14891 and ÖNORM B 3407 W1-W6), as well as for gluing ceramic coverings in floor area for strong thermal or mechanical loads, such as balconies and terraces (especially for gluing fine stoneware), etc. Sealing and adhesion must take place in two steps!

Consumption: as compound seal: approx. 1.5 kg/m² per mm as adhesive: approx. 3 kg/m² depending on tile format





Sealing and Decoupling Membrane **AE100**

Waterproof, tension relieving, flexible, crack-bridging, alkali-resistant sealing and decoupling membrane for safe surface sealing in conjunction with tiles, boards and natural stone. Especially suited for rapid further processing, while at the same time guaranteeing an even layer thickness! For producing a compound seal inside and outside directly under the ceramic covering for the wall and floor area, showers, domestic baths, public as well as private balconies and terraces as well as in commercial kitchens. According to ÖNORM B 3407 W1-W6, according to DIN 18534 for water impact class WO-I to W3-I (for W3-I without additional chemical load and only as special construction), according to DIN 18531-5 (balconies, loggias, etc.) and DIN 18535 (swimming pools and containers), as well as according to the test principles for issuance of a general building inspection test certificate.



Universal Seal **PU 500**

Elastic, solvent-free, water-impermeable, thixotropic, permanently elastic, seamless and jointless two-component compound seal based on polyurethane. For indoor and outdoor sealing on both horizontal and vertical surfaces. Can be used under a wide variety of ceramic surface coverings in accordance with EN 14891, ÖNORM B 3407 W1-W6, DIN 18534 for water exposure class WO-I to W3-I, DIN 18531-5 (balconies, loggias, etc.) and DIN 18535 (swimming pools and tanks), as well as in accordance with the test principles for issuing a general test certificate from the building authorities. Can be used in swimming pools, large kitchens, industrial wet rooms, showers, bathrooms, etc.

Consumption: approx. 1.9 kg/m² per mm layer thickness



Sealing tape **DB 70**

Fabric-reinforced, elastic sealing tape with a fabric-free zone, fabric edge protruding on both sides, fleece coating on both sides for optimum embedding, water-impermeable, chemically-resistant to diluted acids, lyes, and saline solutions. System components for sealing in wall and floor areas, both indoors as well as outdoors. For bridging and sealing connecting and corner joints. Also suitable for swimming pools.

Consumption: Consider an overlap of min. 5 cm



Sealing collar

Sealing collar lined with fleece on both sides and with very elastic expansion zone to absorb movements. In this way it is possible to seal different pipe diameters. Murexin sealing collars are water-impermeable, as well as chemically resistant to diluted acids, lyes and saline solutions. System components for sealing water inflow/drains in conjunction with Murexin sealing products or systems.



Gully Sealing

Fleece laminated on both sides and very elastic sealing mat with perforated edge zones for optimum water impermeable embedding in Murexin compound seals. Chemically resistant to diluted acids, lyes, and saline solutions. System components for sealing gullies and floor outlets in conjunction with sealing systems.



Gradient sealing corners

Prefabricated sealing corner, laminated on both sides with fleece, for filling or sealing of corners of a gradient screed in floor-level showers. These shaped parts are for the transition of the gradient screed and horizontal screed to the rising wall. System components in conjunction with Murexin sealing products or systems.

MUREXIN

MUREXIN GmbH

A-2700 Wiener Neustadt, Franz von Furtenbach Straße 1
Tel.: +43/2622/27 401-0, E-Mail: info@murexin.com

Deutschland: Murexin GmbH

D- 63165 Mühlheim am Main, Industriestraße 25-27
Tel.: +49/6108 7099-2000
E-Mail: info@murexin.de

Ungarn: Murexin Kft.

H-1103 Budapest, Noszlopy u. 2-6.
Tel.: +36/1/262 60 00
E-Mail: murexin@murexin.hu

Tschechien: Murexin spol. s. r. o.

CZ-664 42 Modřice, Brněnská 679
Tel.: +420/5/484 26 711,
E-Mail: murexin@murexin.cz

Slowakei: Murexin spol. s. r. o.

SK-831 04 Bratislava, Odborárska 52
Tel.: +421/2/492 77 224
E-Mail: murexin@murexin.sk

Slowenien: Murexin d.o.o.

SLO-9201 Puconci, Puconci 393
Tel.: +386/2/545 95 00
E-Mail: info@murexin.si

Rumänien: MUREXIN SRL

RO-077045 Chitila, Catted Business Park Chitila
Tel.: +4/021/252 62 51
E-Mail: info@murexin.ro

Frankreich: Murexin France Sarl,

FR-67100 Strasbourg, 28 Rue Schweighaeuser
Tel.: +33/607 262 438
E-Mail: info@murexin.fr

Kroatien: Murexin d. o. o.

HR-10255 Donji Stupnik, Stupničke Škipkovine 4b
E-Mail: info@murexin.hr

Schweiz: Murexin AG

CH-8303 Bässersdorf, Hardstrasse 20
Tel.: +41/44/877 70 30
E-Mail: info@murexin.ch

Vertrieb für Italien:

Murexin GmbH, A-2700 Wiener Neustadt, Franz von Furtenbach Straße 1, Tel.: +43(0)2622/27 401-0, E-Mail: info@murexin.com

Subject to typesetting and printing errors. Edition: 01/2025. We would like to point out that the photos used are only symbolic photos and that these objects do not require our products but only demonstrate areas of application, unless they are explicitly mentioned as reference objects.

It lasts.